

DRYWALL SANDER INSTRUCTION MANUAL

Model No. DP-600E

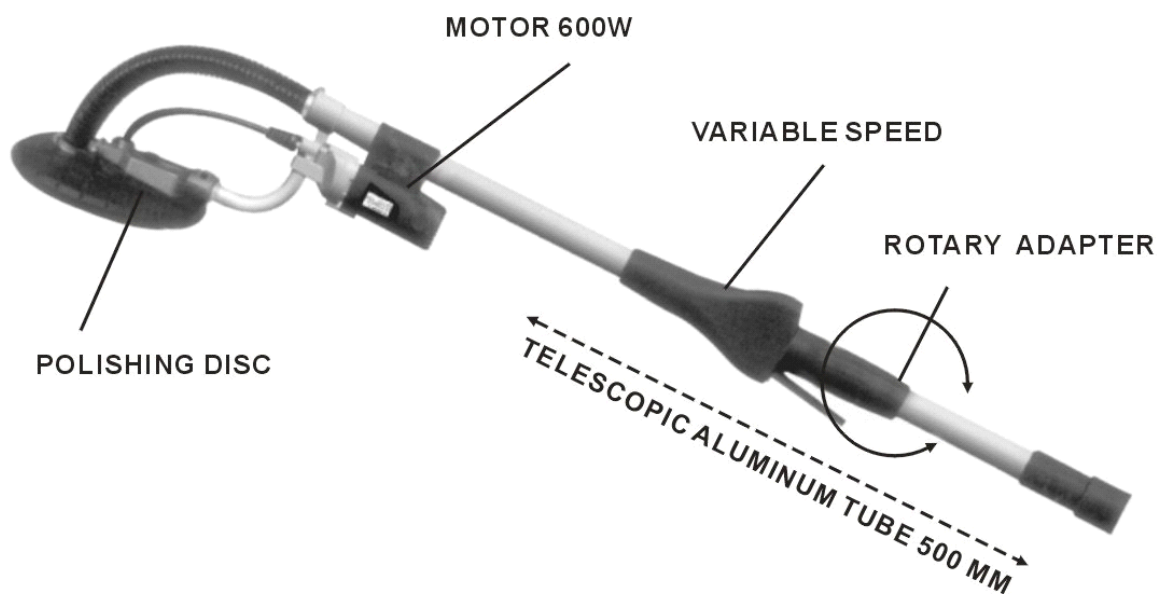

READ THROUGH CAREFULLY AND UNDERSTAND THESE INSTRUCTIONS BEFORE USE

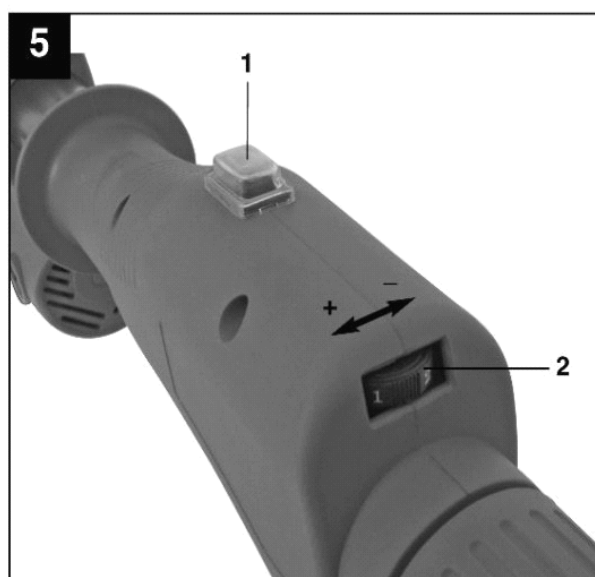
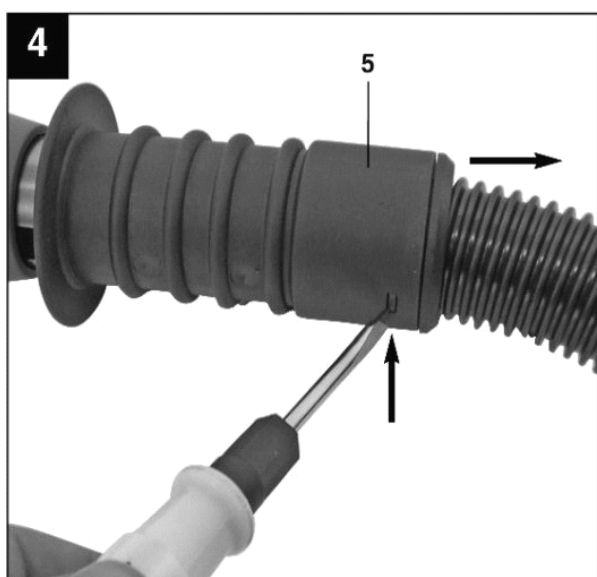
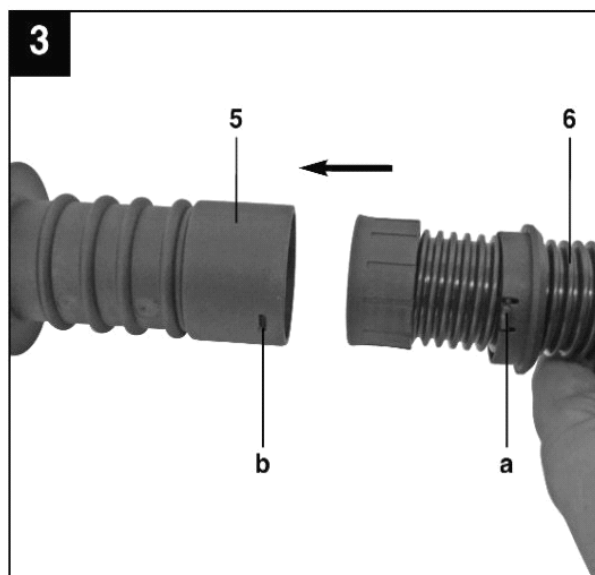
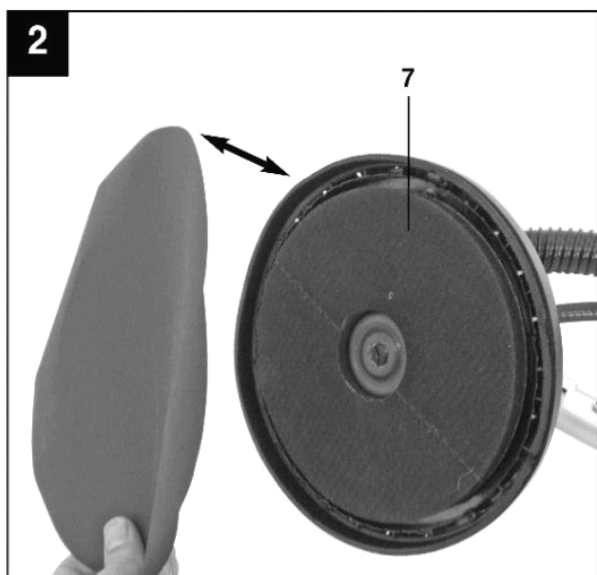
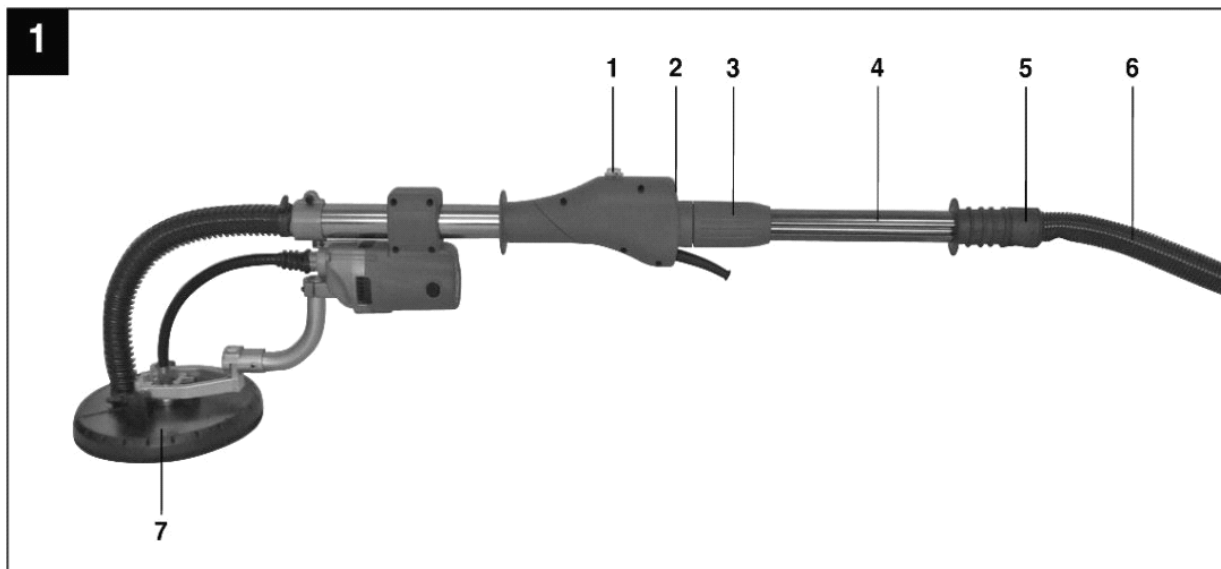

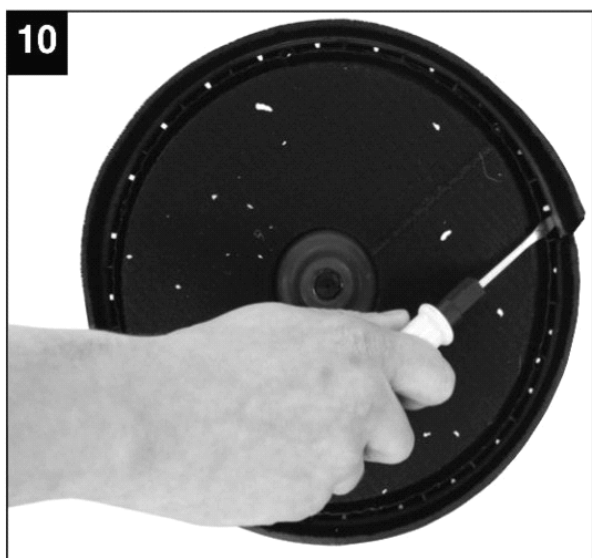
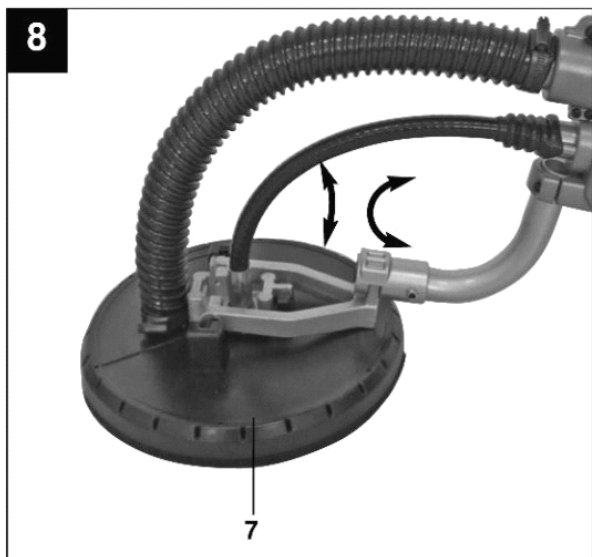
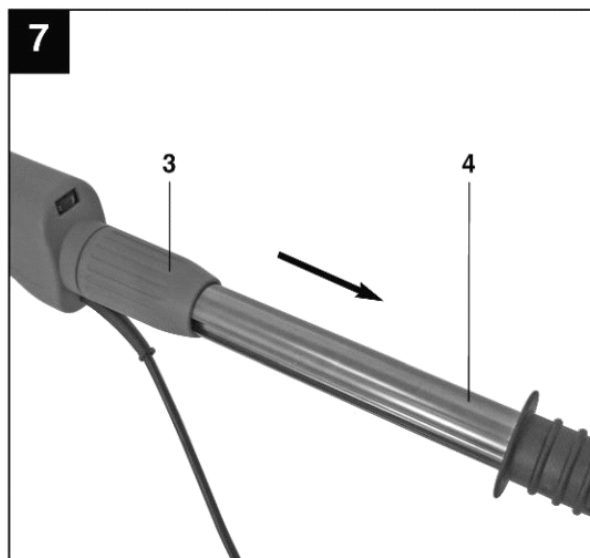
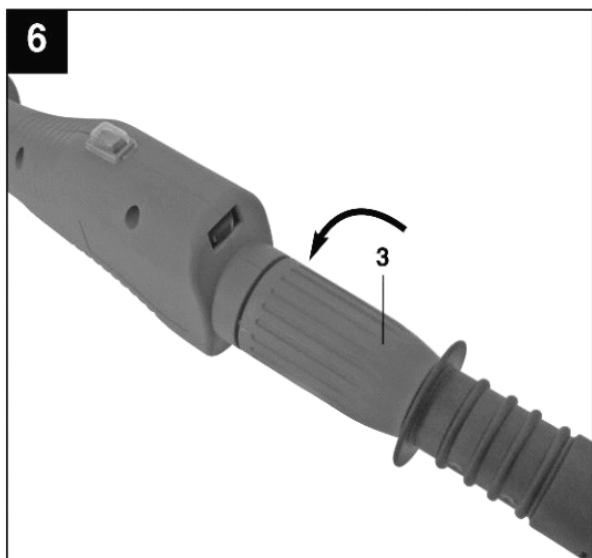



“Caution - Read the operating instructions to reduce the risk of injury”



Wear ear-muffs.

The impact of noise can cause damage to hearing.



Wear a breathing mask.

Dust which is injurious to health can be generated when working on wood and other materials. Never use the device to work on any materials containing asbestos!



Wear safety goggles.

Sparks generated during working or splinters, chips and dust emitted by the device can cause loss of sight.

Important!

When using equipment, a few safety precautions must be observed to avoid injuries and damage. Please read the complete operating manual with due care. Keep this manual in a safe place, so that the information is available at all times. If you give the equipment to any other person, give them these operating instructions as well. We accept no liability for damage or accidents which arise due to non-observance of these instructions and the safety information.

1. Safety regulations

The corresponding safety information can be found in the enclosed booklet.

CAUTION!

Read all safety regulations and instructions.

Any errors made in following the safety regulations and instructions may result in an electric shock, fire and/or serious injury.

Keep all safety regulations and instructions in a safe place for future use.

2. Layout (Fig.1)

- 1 On/Off switch
- 2 Speed regulation
3. Lock for telescopic length extension
4. Telescopic length extension
5. Dust extraction holder
6. Dust extraction hose
7. Sanding/grinding disk

Items supplied

- Drywall Power Sander
- 6x Abrasive paper
- 4m Extraction hose
- 1 pair carbon brushes
- Screwdriver
- Brush ring

3. Intended use

The drywall power sander is designed for sanding/grinding of smoothed dry mortarless walls, for interior ceilings and walls, as well as to remove residual hangings, colour, coverings, glue and loose plaster. The appliance can also be used to grind/sand floors.

The appliance may only be used for the tasks it is designed to handle. Any other use is deemed to be a case of misuse. The user/operator - not the manufacturer - will be liable for any damage or injuries caused as a result thereof.

Please note that our appliance has not been designed for use in commercial, trade or industrial applications.

Our warranty will be voided if the appliance is used in commercial, trade or industrial businesses or for equivalent purposes.

4. Technical data

Mains connection	230 Volt ~ 50 Hz
Power input	600 W
Oscillation rate	1000-2000 rpm
Abrasive paper size	Ø 212 mm
Protection class:	II / 
Weight	4.80 kg

Sound and vibration

Sound and vibration values were measured in accordance with EN 60745.

L _{pA} Sound pressure level	75.5 dB(A)
K _{pA} Uncertainty	3 dB
L _{WA} Sound power level	86.5 dB(A)
K _{WA} Uncertainty	3 dB

Wear ear-muffs.

The impact of noise can cause damage to hearing.

Overall oscillation value determined according to EN 60745

Vibration emission value $a_h \leq 2.5 \text{ m/s}^2$

Caution:

The vibration value changes according to the area of application of the electric tool and may exceed the specified value in exceptional circumstances.

Keep the noise emissions and vibrations to a minimum.

- Only use appliances which are in perfect working order.
- Service and clean the appliance regularly.
- Adapt your working style to suit the appliance.

- Do not overload the appliance.
- Have the appliance serviced whenever necessary.
- Switch the appliance off when it is not in use.
- Wear protective gloves.

5. Before starting the appliance

Before you connect the appliance to the mains supply make sure that the data on the rating plate are identical to the mains data.

Always pull the power plug before making adjustments to the appliance.

5.1 Changing the abrasive paper (Fig. 2)

The sanding/grinding disk comes with a Velcro fastening system for sanding/grinding paper. This permits new sanding/grinding paper to be attached without a clamping device.

Before you attach a new piece of sanding/grinding paper, knock out any dirt from the Velcro fastener and clean with a brush or, if necessary, with compressed air.

Place the sanding/grinding paper on the sanding/grinding disk. Fix the sanding/grinding paper in place by pressing it firmly with your hand.

Caution:

Only grinding wheels with the specified diameter may be used.

5.2 Fitting the dust extraction system (Fig 3/4)

The dust extraction system prevents the accumulation of dirt and high dust loads in the air, and it makes it easier to dispose of the dust.

- Insert the dust extraction hose (6) into the mount (5) Both interlocking lugs (a) should be snapped into the notches (b) in the mount.
- To dismantle the hose, carefully press into the notches with the flat side of the enclosed screwdriver. By doing this, the interlocking lugs are released from the notches and the hose can be taken back out of the mount.
- Connect your appliance to an extraction unit or vacuum cleaner. This will provide excellent extraction of chips and dust from the workpiece.

Advantages: The advantages are that you will protect both the appliance and your own health. Your work area will also be clean and safe.

6. Starting up

6.1 ON/OFF switch (Fig. 5)

To switch on the appliance set the On/Off switch (1) to position 1.

Move the On/Off switch (1) to position 0 to switch off the appliance.

6.2 Speed controller (Fig. 5)

To pre-select the speed turn the knurled screw (2) on the switch.

Plus direction: Higher speed

Minus direction: Lower speed

6.3 Using the telescopic length extension (Fig. 6/7)

Unscrew the lock for the telescopic length extension (3) approx. 2-3 turns (Fig. 6) Now the telescopic length extension (4) can be pulled out (Fig. 7)

6.4 Swivelling grinding/sanding disk (Fig. 8)

The grinding/sanding disk swivels on 2 different axes and therefore enables comfortable grinding/sanding even for overhead work and for working in small spaces.

7. Replacing the power cable

If the power cable for this appliance is damaged, it must be replaced by the manufacturer or its after-sales service or similarly trained personnel to avoid danger.

8. Cleaning, maintenance and ordering of spare parts

Always pull out the mains power plug before starting any cleaning work.

8.1 Cleaning

- Keep all safety devices, air vents and the motor housing free of dirt and dust as far as possible. Wipe the appliance with a clean cloth or blast it with compressed air at low pressure.
- We recommend that you clean the appliance immediately after you use it.
- Clean the appliance regularly with a damp cloth and some soft soap. Do not use cleaning agents or solvents; these may be aggressive to the plastic parts in the appliance. Ensure that no water can get into the interior of the appliance.

8.2 Carbon brushes

In case of excessive sparking, have the carbon brushes checked only by a qualified electrician.

Caution: The carbon brushes should not be replaced by anyone but a qualified electrician.

8.3 Servicing

There are no parts inside the appliance which require additional maintenance.

8.4 Ordering replacement parts:

Please provide the following information on all orders for spare parts:

- Model/type of the appliance
- Article number of the appliance
- ID number of the appliance
- Spare part number of the required spare part

For our latest prices and information please go to www.isc-gmbh.info

8.5 Changing the brush ring (Fig. 9/10)

Loosen the six screws with a screwdriver.

Lift the brush ring carefully out with the screwdriver.

To assemble the new brush ring proceed in reverse order.

9. Disposal and recycling

The appliance is supplied in packaging to prevent its being damaged in transit. This packaging is raw material and can therefore be reused or can be returned to the raw material system.

The appliance and its accessories are made of various types of material, such as metal and plastic. Defective components must be disposed of as special waste. Ask your dealer or your local council.

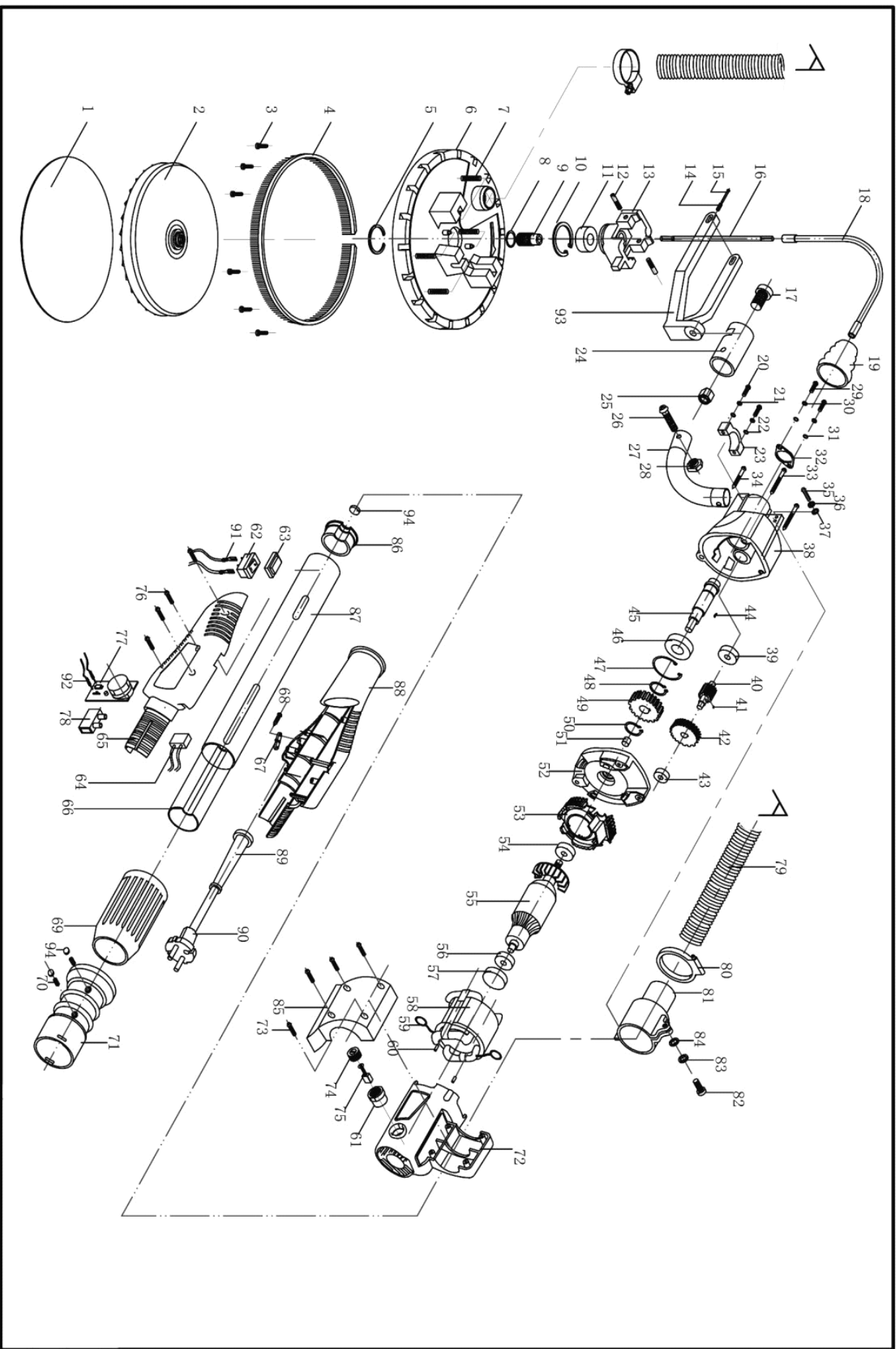

DP-600E spare parts list

NO.	spare part description	quantity	NO.	spare part description	quantity
1	sandpaper		48	outer snap spring	
2	adhibit tray		49	big straight gear	
3	screw ST3.9x14		50	outer snap spring	
4	nylon brush		51	copper sleeve	
5	snap ring		52	middle cover	
6	plastic disc		53	baffle ring	
7	spring		54	bearing 608	
8	flat washer		55	armature	
9	thread axes		56	bearing 607	
10	inner snap spring		57	bearing sheath	
11	bearing 6001		58	stator	
12	guide pin		59	pull ring	
13	bearing seat		60	cable plate	
14	spring		61	brush pot	
15	Pin nail		62	switch	
16	drive shaft		63	switch cover	
17	screw M8x24		64	Inductance	
18	plastic tube		65	left safe cover	
19	tube sheath		66	extension tube	
20	screw M4x25		67	pressure plate	
21	spring washer		68	screw ST4x16	
22	flat washer		69	locking nut	
23	tube clamp plate		70	screw M4x10	
24	tube tie -in		71	vacuum adapter hsg	
25	join screw column		72	shell	
26	screw M5x35		73	screw M4x18	
27	support tube		74	brush cover	
28	join screw column		75	carbon brush	
29	screw M4x12		76	screw ST4x18	
30	spring washer		77	variable speed control	
31	flat washer		78	terminal block	
32	flexible shaft lockplate		79	hose	
33	screw ST4x55		80	snap ring	
34	screw ST4x35		81	hose joint	
35	screw M4x12		82	screw M6x20	
36	spring washer		83	spring washer	
37	flat washer		84	flat washer	
38	gear hsg		85	shell cover	
39	bearing 607		86	sealing ring	
40	gear shaft		87	aluminum main tube	
41	steel ball ϕ 3		88	right safe cover	
42	big gear		89	cable shield sheath	
43	bearing 606		90	dust plug	
44	spindle		91	insert spring	
45	screw		92	insert spring	
46	bearing 6002		93	support arm	
47	inner snap spring		94	plastic cap	